

Beal Cattle Co.
12100 E Richmond Rd.
Glencoe, OK 74032
540-230-5049



Supplement Update

2020 Oklahoma Prime Angus Female Sale

Sale Date: 10/2/20; Date of Update: 10/1/20

UPDATE FOR **LiveAuctions.TV 2.0**

LiveAuctions.tv has moved to a new system. As a result, to use LiveAuctions.tv (version 2.0) to bid online for the 2020 Oklahoma Prime sale, **please create a new account** if you have not already done so this fall. Please follow the steps provided below. Your previous login will no longer work. We encourage you to setup your account in advance of the sale and login early to familiarize yourself with the new system. If you have any troubles, please contact LiveAuctions.tv support at 817-725-8595 or call Erick Schmidt at 830-263-0166.

If you have any problems bidding online, please do not hesitate to call one of the sale day phones listed below during the sale.

Sale Day Phones:

Colin Beal: 540-230-5049
Dr. Bill Beal: 540-230-2770
Jeff Mafi: 816-344-4266
Chisholm Kinder: 405-747-4683
Mitchell Armitage: 405-641-9438
Brennan Lewis: 918-617-7174
Curtis Bryant: 410-967-8704

LiveAuctions.TV 2.0

Please create a NEW account to use this version

Follow these steps

To Login
Click "Login" located in the top right
Or select the sale you are interested in
You will now see a login screen with Email Address and Password fields
Click "Create an Account" below the blue login button

Creating an Account
Enter your accurate information into all fields
Click "Terms of Service" highlighted in blue
Read the terms and click "I Agree" in green at the bottom.
Then check the box that says you read and agree to the terms.
Now, click "Register"

**Be sure to check "Remember Me" if it is your personal computer or phone before clicking "Login"*

Registering for a Buyer Number
From the homepage, choose the sale you're interested in
Once selected, click "Request a Buyer Number"
Verify your Email Address with the email verification link
Next, to verify your mobile number, click "Send Token"
Authorize token by using the verification code sent to your mobile device and "Submit"
Click "Continue"

**Special Instructions can include details for trucking, payment, registration*

No Smartphone or Tablet App Required!
View everything from your favorite browser today!

For additional sale information (printable sale order, supplement sheet, etc.)
click "Auction Details" in blue in the top left-hand corner of the page.

Customer Service Line (817) 725-8595

Beal Cattle Co.
 12100 E Richmond Rd.
 Glencoe, OK 74032
 540-230-5049



2020 Oklahoma Prime Pen Diagram

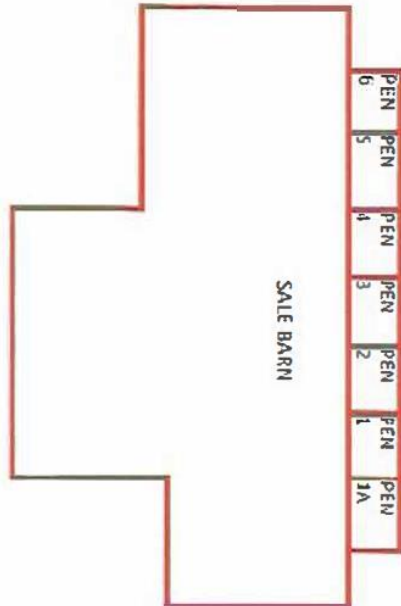
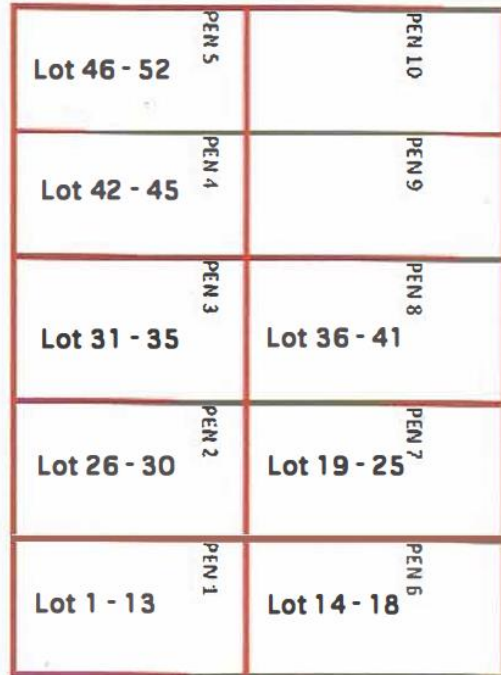
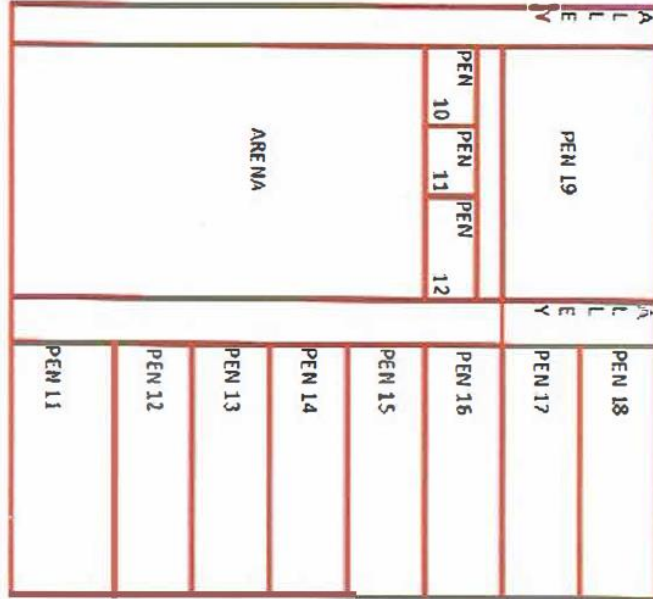



Lot	Update Information																																																																																																																																																																																																																																																																																											
Lot 1	<p>Lot 1A (heifer calf, Beal Prophet K263 270) was born 9/14/20 and weighed 70 lbs. The calf is registered (19819098) and DNA has been submitted for the AngusGS genomic test. DNA results have not yet been received, but interim EPDs are provided below.</p> <table border="1" style="margin-left: auto; margin-right: auto;"> <thead> <tr> <th colspan="14" style="text-align: center;">270 Beal Prophet K263 270</th> </tr> <tr> <th>Adj Yrig</th> <td colspan="3">Birth Dt: 09/14/20</td> <td colspan="3">Cow</td> <td colspan="3">19819098</td> <td colspan="4">Tattoo: 270</td> </tr> <tr> <th>Hip Ht</th> <td colspan="2">CED</td> <td colspan="2">BW</td> <td colspan="2">WW</td> <td colspan="2">YW</td> <td colspan="2">RADG</td> <td colspan="2">DMI</td> <td colspan="1">YH</td> </tr> <tr> <td></td> <td>I+11</td> <td>15%</td> <td>I+5</td> <td>35%</td> <td>I+75</td> <td>5%</td> <td>I+135</td> <td>4%</td> <td>I+.28</td> <td>20%</td> <td>I+1.75</td> <td>95%</td> <td>I+.8</td> <td>20%</td> </tr> <tr> <th>Adj Yrig</th> <td colspan="2">SC</td> <td colspan="2">Doc</td> <td colspan="2">HP</td> <td colspan="2">CEM</td> <td colspan="2">Milk</td> <td colspan="2">MW</td> <td colspan="1">MH</td> </tr> <tr> <th>Scr Cir</th> <td>I+.31</td> <td>80%</td> <td>I+30</td> <td>4%</td> <td>I+12.6</td> <td>35%</td> <td>I+8</td> <td>55%</td> <td>I+32</td> <td>10%</td> <td>I+59</td> <td>45%</td> <td>I+.8</td> <td>10%</td> </tr> <tr> <th>Adj</th> <td colspan="3">\$EN</td> <td colspan="3">CW</td> <td colspan="3">Marb</td> <td colspan="3">RE</td> <td colspan="1">Fat</td> <td colspan="1">\$M</td> </tr> <tr> <th>% IMF</th> <td colspan="2">-21</td> <td colspan="2">80%</td> <td colspan="2">I+63</td> <td colspan="2">10%</td> <td colspan="2">I+1.12</td> <td colspan="2">10%</td> <td colspan="2">I+1.05</td> <td colspan="1">4%</td> <td colspan="1">I-.018</td> <td colspan="1">15%</td> <td colspan="1">+78</td> </tr> <tr> <th>% IMF</th> <td colspan="14"> <table border="0" style="width: 100%;"> <tr> <td style="width: 33%;"></td> <td style="width: 33%;">C R A Bextor 872 5205 608 [AMF-CAF-XF]</td> <td style="width: 33%;">+10%</td> </tr> <tr> <td></td> <td>G A R Prophet [AMF-CAF-XF]</td> <td>\$W</td> </tr> <tr> <td></td> <td>G A R Objective 1885 [AMF-DDF-NHF]</td> <td>+89</td> </tr> <tr> <td></td> <td></td> <td>1%</td> </tr> <tr> <td></td> <td></td> <td>\$F</td> </tr> <tr> <td></td> <td>G A R New Design 5050 [DDC-AMF-XF]</td> <td>+105</td> </tr> <tr> <td></td> <td>Chair Rock 5050 G A R 1131 [DDF]</td> <td>5%</td> </tr> <tr> <td></td> <td>Chair Rock Objective 7042</td> <td>\$G</td> </tr> <tr> <td></td> <td></td> <td>+82</td> </tr> <tr> <td></td> <td>G A R Sure Fire [AMF-CAF-XF]</td> <td>2%</td> </tr> <tr> <td></td> <td>Chair Rock 5050 G A R 8086 [DDC]</td> <td>\$B</td> </tr> <tr> <td></td> <td></td> <td>+187</td> </tr> <tr> <td></td> <td>H P C A Sure Fire S6 [OSF]</td> <td>1%</td> </tr> <tr> <td></td> <td>*18424079</td> <td>\$C</td> </tr> <tr> <td></td> <td>H P C A Ingenuity A372 [DDF]</td> <td>+321</td> </tr> <tr> <td></td> <td>G A R Predestined 287L [DDF]</td> <td>1%</td> </tr> </table> </td> </tr> <tr> <th>Rib Fat</th> <td colspan="2">BW</td> <td colspan="2">CE</td> <td colspan="2">BWR</td> <td colspan="2">ADJ WW</td> <td colspan="2">WWR</td> <td colspan="2">ADJ YW</td> <td colspan="2">YWR</td> <td colspan="2">Test ADG</td> <td colspan="1">GR</td> </tr> <tr> <td></td> <td colspan="2">70</td> <td colspan="2">1</td> <td colspan="2"></td> <td colspan="2"></td> <td colspan="2"></td> <td colspan="2"></td> <td colspan="2"></td> <td colspan="2"></td> <td colspan="1"></td> </tr> <tr> <th>Adj Rump Fat</th> <td colspan="7">Dam's Production Record</td> <td colspan="7">Dam's Ultrasound Production Record</td> </tr> <tr> <td></td> <td colspan="2">ACT BW</td> <td colspan="2">BWR</td> <td colspan="2">WWR</td> <td colspan="2">YWR</td> <td colspan="2">% IMF</td> <td colspan="2">RE</td> <td colspan="2">Fat</td> <td colspan="2">RU Fat</td> </tr> <tr> <td></td> <td colspan="2">1-70</td> <td colspan="2">1-100</td> <td colspan="2">1-100</td> <td colspan="2"></td> <td colspan="2"></td> <td colspan="2"></td> <td colspan="2"></td> <td colspan="2"></td> </tr> <tr> <th>Rump Fat Ratio</th> <td colspan="14"></td> </tr> </thead></table>	270 Beal Prophet K263 270														Adj Yrig	Birth Dt: 09/14/20			Cow			19819098			Tattoo: 270				Hip Ht	CED		BW		WW		YW		RADG		DMI		YH		I+11	15%	I+5	35%	I+75	5%	I+135	4%	I+.28	20%	I+1.75	95%	I+.8	20%	Adj Yrig	SC		Doc		HP		CEM		Milk		MW		MH	Scr Cir	I+.31	80%	I+30	4%	I+12.6	35%	I+8	55%	I+32	10%	I+59	45%	I+.8	10%	Adj	\$EN			CW			Marb			RE			Fat	\$M	% IMF	-21		80%		I+63		10%		I+1.12		10%		I+1.05		4%	I-.018	15%	+78	% IMF	<table border="0" style="width: 100%;"> <tr> <td style="width: 33%;"></td> <td style="width: 33%;">C R A Bextor 872 5205 608 [AMF-CAF-XF]</td> <td style="width: 33%;">+10%</td> </tr> <tr> <td></td> <td>G A R Prophet [AMF-CAF-XF]</td> <td>\$W</td> </tr> <tr> <td></td> <td>G A R Objective 1885 [AMF-DDF-NHF]</td> <td>+89</td> </tr> <tr> <td></td> <td></td> <td>1%</td> </tr> <tr> <td></td> <td></td> <td>\$F</td> </tr> <tr> <td></td> <td>G A R New Design 5050 [DDC-AMF-XF]</td> <td>+105</td> </tr> <tr> <td></td> <td>Chair Rock 5050 G A R 1131 [DDF]</td> <td>5%</td> </tr> <tr> <td></td> <td>Chair Rock Objective 7042</td> <td>\$G</td> </tr> <tr> <td></td> <td></td> <td>+82</td> </tr> <tr> <td></td> <td>G A R Sure Fire [AMF-CAF-XF]</td> <td>2%</td> </tr> <tr> <td></td> <td>Chair Rock 5050 G A R 8086 [DDC]</td> <td>\$B</td> </tr> <tr> <td></td> <td></td> <td>+187</td> </tr> <tr> <td></td> <td>H P C A Sure Fire S6 [OSF]</td> <td>1%</td> </tr> <tr> <td></td> <td>*18424079</td> <td>\$C</td> </tr> <tr> <td></td> <td>H P C A Ingenuity A372 [DDF]</td> <td>+321</td> </tr> <tr> <td></td> <td>G A R Predestined 287L [DDF]</td> <td>1%</td> </tr> </table>															C R A Bextor 872 5205 608 [AMF-CAF-XF]	+10%		G A R Prophet [AMF-CAF-XF]	\$W		G A R Objective 1885 [AMF-DDF-NHF]	+89			1%			\$F		G A R New Design 5050 [DDC-AMF-XF]	+105		Chair Rock 5050 G A R 1131 [DDF]	5%		Chair Rock Objective 7042	\$G			+82		G A R Sure Fire [AMF-CAF-XF]	2%		Chair Rock 5050 G A R 8086 [DDC]	\$B			+187		H P C A Sure Fire S6 [OSF]	1%		*18424079	\$C		H P C A Ingenuity A372 [DDF]	+321		G A R Predestined 287L [DDF]	1%	Rib Fat	BW		CE		BWR		ADJ WW		WWR		ADJ YW		YWR		Test ADG		GR		70		1															Adj Rump Fat	Dam's Production Record							Dam's Ultrasound Production Record								ACT BW		BWR		WWR		YWR		% IMF		RE		Fat		RU Fat			1-70		1-100		1-100												Rump Fat Ratio														
270 Beal Prophet K263 270																																																																																																																																																																																																																																																																																												
Adj Yrig	Birth Dt: 09/14/20			Cow			19819098			Tattoo: 270																																																																																																																																																																																																																																																																																		
Hip Ht	CED		BW		WW		YW		RADG		DMI		YH																																																																																																																																																																																																																																																																															
	I+11	15%	I+5	35%	I+75	5%	I+135	4%	I+.28	20%	I+1.75	95%	I+.8	20%																																																																																																																																																																																																																																																																														
Adj Yrig	SC		Doc		HP		CEM		Milk		MW		MH																																																																																																																																																																																																																																																																															
Scr Cir	I+.31	80%	I+30	4%	I+12.6	35%	I+8	55%	I+32	10%	I+59	45%	I+.8	10%																																																																																																																																																																																																																																																																														
Adj	\$EN			CW			Marb			RE			Fat	\$M																																																																																																																																																																																																																																																																														
% IMF	-21		80%		I+63		10%		I+1.12		10%		I+1.05		4%	I-.018	15%	+78																																																																																																																																																																																																																																																																										
% IMF	<table border="0" style="width: 100%;"> <tr> <td style="width: 33%;"></td> <td style="width: 33%;">C R A Bextor 872 5205 608 [AMF-CAF-XF]</td> <td style="width: 33%;">+10%</td> </tr> <tr> <td></td> <td>G A R Prophet [AMF-CAF-XF]</td> <td>\$W</td> </tr> <tr> <td></td> <td>G A R Objective 1885 [AMF-DDF-NHF]</td> <td>+89</td> </tr> <tr> <td></td> <td></td> <td>1%</td> </tr> <tr> <td></td> <td></td> <td>\$F</td> </tr> <tr> <td></td> <td>G A R New Design 5050 [DDC-AMF-XF]</td> <td>+105</td> </tr> <tr> <td></td> <td>Chair Rock 5050 G A R 1131 [DDF]</td> <td>5%</td> </tr> <tr> <td></td> <td>Chair Rock Objective 7042</td> <td>\$G</td> </tr> <tr> <td></td> <td></td> <td>+82</td> </tr> <tr> <td></td> <td>G A R Sure Fire [AMF-CAF-XF]</td> <td>2%</td> </tr> <tr> <td></td> <td>Chair Rock 5050 G A R 8086 [DDC]</td> <td>\$B</td> </tr> <tr> <td></td> <td></td> <td>+187</td> </tr> <tr> <td></td> <td>H P C A Sure Fire S6 [OSF]</td> <td>1%</td> </tr> <tr> <td></td> <td>*18424079</td> <td>\$C</td> </tr> <tr> <td></td> <td>H P C A Ingenuity A372 [DDF]</td> <td>+321</td> </tr> <tr> <td></td> <td>G A R Predestined 287L [DDF]</td> <td>1%</td> </tr> </table>															C R A Bextor 872 5205 608 [AMF-CAF-XF]	+10%		G A R Prophet [AMF-CAF-XF]	\$W		G A R Objective 1885 [AMF-DDF-NHF]	+89			1%			\$F		G A R New Design 5050 [DDC-AMF-XF]	+105		Chair Rock 5050 G A R 1131 [DDF]	5%		Chair Rock Objective 7042	\$G			+82		G A R Sure Fire [AMF-CAF-XF]	2%		Chair Rock 5050 G A R 8086 [DDC]	\$B			+187		H P C A Sure Fire S6 [OSF]	1%		*18424079	\$C		H P C A Ingenuity A372 [DDF]	+321		G A R Predestined 287L [DDF]	1%																																																																																																																																																																																																																														
	C R A Bextor 872 5205 608 [AMF-CAF-XF]	+10%																																																																																																																																																																																																																																																																																										
	G A R Prophet [AMF-CAF-XF]	\$W																																																																																																																																																																																																																																																																																										
	G A R Objective 1885 [AMF-DDF-NHF]	+89																																																																																																																																																																																																																																																																																										
		1%																																																																																																																																																																																																																																																																																										
		\$F																																																																																																																																																																																																																																																																																										
	G A R New Design 5050 [DDC-AMF-XF]	+105																																																																																																																																																																																																																																																																																										
	Chair Rock 5050 G A R 1131 [DDF]	5%																																																																																																																																																																																																																																																																																										
	Chair Rock Objective 7042	\$G																																																																																																																																																																																																																																																																																										
		+82																																																																																																																																																																																																																																																																																										
	G A R Sure Fire [AMF-CAF-XF]	2%																																																																																																																																																																																																																																																																																										
	Chair Rock 5050 G A R 8086 [DDC]	\$B																																																																																																																																																																																																																																																																																										
		+187																																																																																																																																																																																																																																																																																										
	H P C A Sure Fire S6 [OSF]	1%																																																																																																																																																																																																																																																																																										
	*18424079	\$C																																																																																																																																																																																																																																																																																										
	H P C A Ingenuity A372 [DDF]	+321																																																																																																																																																																																																																																																																																										
	G A R Predestined 287L [DDF]	1%																																																																																																																																																																																																																																																																																										
Rib Fat	BW		CE		BWR		ADJ WW		WWR		ADJ YW		YWR		Test ADG		GR																																																																																																																																																																																																																																																																											
	70		1																																																																																																																																																																																																																																																																																									
Adj Rump Fat	Dam's Production Record							Dam's Ultrasound Production Record																																																																																																																																																																																																																																																																																				
	ACT BW		BWR		WWR		YWR		% IMF		RE		Fat		RU Fat																																																																																																																																																																																																																																																																													
	1-70		1-100		1-100																																																																																																																																																																																																																																																																																							
Rump Fat Ratio																																																																																																																																																																																																																																																																																												
Lot 2	N187 was flushed in April and May of 2020 and produced 22 embryos. She showed heat and was bred AI in June but did not conceive. She was not pasture exposed to a bull. She was checked open in September and showed heat on 9/20/20. Sells OPEN and ready to breed or flush with a breeding guarantee.																																																																																																																																																																																																																																																																																											
Lot 5	406 calved on 3/30/20 (calf is not in the sale) and was flushed in May of 2020 and produced 12 embryos. She showed heat and was bred AI in July but did not conceive. She was not pasture exposed to a bull. She was checked open in September. Sells OPEN and ready to breed or flush with a breeding guarantee.																																																																																																																																																																																																																																																																																											
Lot 7	29 was checked pregnant in September and due to calve on 3/9/21 to GAR Quantum.																																																																																																																																																																																																																																																																																											
Lot 9	149 was checked pregnant in September and due to calve on 4/1/21 to GAR Prophet K263.																																																																																																																																																																																																																																																																																											

Beal Cattle Co.
 12100 E Richmond Rd.
 Glencoe, OK 74032
 540-230-5049



<p>Lot 11</p>	<p>2038 was flushed 1 time to average 9 embryos. Lot 11A (bull calf, Beal Quantum 350B) was born 9/23/20 and weighed 81 lbs. The calf is registered (19824900) and DNA has been submitted for the AngusGS genomic test. DNA results have not yet been received, but interim EPDs are provided below.</p> <p style="text-align: center;">Beal Quantum 350B</p> <table border="1" style="width: 100%; border-collapse: collapse;"> <tr> <td>Adj Yrlg</td> <td colspan="2">Birth Dt: 09/23/20</td> <td colspan="2">Bull</td> <td colspan="2">19824900</td> <td colspan="2">Tattoo: 350B</td> </tr> <tr> <td>Hip Ht</td> <td>GED</td> <td>BW</td> <td>WW</td> <td>YW</td> <td>RADG</td> <td>DMI</td> <td>YH</td> <td></td> </tr> <tr> <td></td> <td>I+14 .05</td> <td>I-.3 .05</td> <td>I+61 .05</td> <td>I+113 .05</td> <td>I+.29 .05</td> <td>I+.80 .05</td> <td>I+.6 .05</td> <td></td> </tr> <tr> <td>Adj Yrlg</td> <td>SC</td> <td>Doc</td> <td>HP</td> <td>CEM</td> <td>Milk</td> <td>MW</td> <td>MH</td> <td></td> </tr> <tr> <td>Scr Cir</td> <td>I+1.44 .05</td> <td>I+27 .05</td> <td>I+8.2 .05</td> <td>I+10 .05</td> <td>I+32 .05</td> <td>I+51 .05</td> <td>I+.5 .05</td> <td></td> </tr> <tr> <td>Adj</td> <td colspan="2">\$EN</td> <td colspan="2">CW</td> <td colspan="2">Marb</td> <td colspan="2">RE</td> </tr> <tr> <td>% IMF</td> <td>-18</td> <td>I+50 .05</td> <td>I+1.20 .05</td> <td>I+1.02 .05</td> <td>I-.010 .05</td> <td></td> <td></td> <td>+61</td> </tr> <tr> <td>% IMF</td> <td></td> <td colspan="2">G A R Momentum [CAF-D2F-XF]</td> <td colspan="2">G A R Progress [DDC-CAF-XF]</td> <td></td> <td></td> <td>\$W</td> </tr> <tr> <td>Ratio</td> <td></td> <td colspan="2"></td> <td colspan="2">G A R Big Eye 1770 [DDF]</td> <td></td> <td></td> <td>+74</td> </tr> <tr> <td>Adj RE</td> <td colspan="2">G A R Quantum [AMF-CAF-XF]</td> <td colspan="2">Connealy In Sure 8524 [AMF-CAF-XF]</td> <td colspan="2"></td> <td></td> <td>\$F</td> </tr> <tr> <td></td> <td colspan="2">+*18636059</td> <td colspan="2">G A R In Sure 1524 [OSF]</td> <td colspan="2"></td> <td></td> <td>+100</td> </tr> <tr> <td>RE</td> <td colspan="2"></td> <td colspan="2">G A R Complete 3011 [DDF]</td> <td colspan="2"></td> <td></td> <td>\$G</td> </tr> <tr> <td>Ratio</td> <td colspan="2"></td> <td colspan="2"></td> <td colspan="2"></td> <td></td> <td>+85</td> </tr> <tr> <td>Adj Rib Fat</td> <td colspan="2">G A R Sure Fire 2038</td> <td colspan="2">Connealy In Sure 8524 [AMF-CAF-XF]</td> <td colspan="2"></td> <td></td> <td>\$B</td> </tr> <tr> <td></td> <td colspan="2">*19266380</td> <td colspan="2">G A R Sure Fire [AMF-CAF-XF]</td> <td colspan="2"></td> <td></td> <td>+185</td> </tr> <tr> <td>Rib Fat</td> <td colspan="2"></td> <td colspan="2">Chair Rock 5050 G A R 8086 [DDC]</td> <td colspan="2"></td> <td></td> <td>\$C</td> </tr> <tr> <td>Ratio</td> <td colspan="2"></td> <td colspan="2">K C F Bennett Absolute [AMF-CAF-XF]</td> <td colspan="2"></td> <td></td> <td>+301</td> </tr> <tr> <td></td> <td colspan="2"></td> <td colspan="2">G A R Absolute N1086</td> <td colspan="2"></td> <td></td> <td></td> </tr> <tr> <td></td> <td colspan="2"></td> <td colspan="2">G A R Daybreak 202 [DDF]</td> <td colspan="2"></td> <td></td> <td></td> </tr> <tr> <td></td> <td>BW</td> <td>CE</td> <td>BWR</td> <td>ADJ WW</td> <td>WWR</td> <td>ADJ YW</td> <td>YWR</td> <td>Test ADG</td> </tr> <tr> <td></td> <td>81</td> <td>1</td> <td></td> <td></td> <td></td> <td></td> <td></td> <td>GR</td> </tr> <tr> <td>Adj Rump Fat</td> <td colspan="8"></td> </tr> <tr> <td>Rump Fat Ratio</td> <td colspan="8"></td> </tr> </table>	Adj Yrlg	Birth Dt: 09/23/20		Bull		19824900		Tattoo: 350B		Hip Ht	GED	BW	WW	YW	RADG	DMI	YH			I+14 .05	I-.3 .05	I+61 .05	I+113 .05	I+.29 .05	I+.80 .05	I+.6 .05		Adj Yrlg	SC	Doc	HP	CEM	Milk	MW	MH		Scr Cir	I+1.44 .05	I+27 .05	I+8.2 .05	I+10 .05	I+32 .05	I+51 .05	I+.5 .05		Adj	\$EN		CW		Marb		RE		% IMF	-18	I+50 .05	I+1.20 .05	I+1.02 .05	I-.010 .05			+61	% IMF		G A R Momentum [CAF-D2F-XF]		G A R Progress [DDC-CAF-XF]				\$W	Ratio				G A R Big Eye 1770 [DDF]				+74	Adj RE	G A R Quantum [AMF-CAF-XF]		Connealy In Sure 8524 [AMF-CAF-XF]					\$F		+*18636059		G A R In Sure 1524 [OSF]					+100	RE			G A R Complete 3011 [DDF]					\$G	Ratio								+85	Adj Rib Fat	G A R Sure Fire 2038		Connealy In Sure 8524 [AMF-CAF-XF]					\$B		*19266380		G A R Sure Fire [AMF-CAF-XF]					+185	Rib Fat			Chair Rock 5050 G A R 8086 [DDC]					\$C	Ratio			K C F Bennett Absolute [AMF-CAF-XF]					+301				G A R Absolute N1086									G A R Daybreak 202 [DDF]							BW	CE	BWR	ADJ WW	WWR	ADJ YW	YWR	Test ADG		81	1						GR	Adj Rump Fat									Rump Fat Ratio								
Adj Yrlg	Birth Dt: 09/23/20		Bull		19824900		Tattoo: 350B																																																																																																																																																																																																									
Hip Ht	GED	BW	WW	YW	RADG	DMI	YH																																																																																																																																																																																																									
	I+14 .05	I-.3 .05	I+61 .05	I+113 .05	I+.29 .05	I+.80 .05	I+.6 .05																																																																																																																																																																																																									
Adj Yrlg	SC	Doc	HP	CEM	Milk	MW	MH																																																																																																																																																																																																									
Scr Cir	I+1.44 .05	I+27 .05	I+8.2 .05	I+10 .05	I+32 .05	I+51 .05	I+.5 .05																																																																																																																																																																																																									
Adj	\$EN		CW		Marb		RE																																																																																																																																																																																																									
% IMF	-18	I+50 .05	I+1.20 .05	I+1.02 .05	I-.010 .05			+61																																																																																																																																																																																																								
% IMF		G A R Momentum [CAF-D2F-XF]		G A R Progress [DDC-CAF-XF]				\$W																																																																																																																																																																																																								
Ratio				G A R Big Eye 1770 [DDF]				+74																																																																																																																																																																																																								
Adj RE	G A R Quantum [AMF-CAF-XF]		Connealy In Sure 8524 [AMF-CAF-XF]					\$F																																																																																																																																																																																																								
	+*18636059		G A R In Sure 1524 [OSF]					+100																																																																																																																																																																																																								
RE			G A R Complete 3011 [DDF]					\$G																																																																																																																																																																																																								
Ratio								+85																																																																																																																																																																																																								
Adj Rib Fat	G A R Sure Fire 2038		Connealy In Sure 8524 [AMF-CAF-XF]					\$B																																																																																																																																																																																																								
	*19266380		G A R Sure Fire [AMF-CAF-XF]					+185																																																																																																																																																																																																								
Rib Fat			Chair Rock 5050 G A R 8086 [DDC]					\$C																																																																																																																																																																																																								
Ratio			K C F Bennett Absolute [AMF-CAF-XF]					+301																																																																																																																																																																																																								
			G A R Absolute N1086																																																																																																																																																																																																													
			G A R Daybreak 202 [DDF]																																																																																																																																																																																																													
	BW	CE	BWR	ADJ WW	WWR	ADJ YW	YWR	Test ADG																																																																																																																																																																																																								
	81	1						GR																																																																																																																																																																																																								
Adj Rump Fat																																																																																																																																																																																																																
Rump Fat Ratio																																																																																																																																																																																																																
<p>Lot 12</p>	<p>129 was flushed in April of 2020 and produced 5 embryos. She showed heat and was bred AI in June but did not conceive. She was not pasture exposed to a bull. She was checked open in September. Sells OPEN and ready to breed or flush with a breeding guarantee.</p>																																																																																																																																																																																																															
<p>Lot 20</p>	<p>OUT of sale</p>																																																																																																																																																																																																															



Lot 27

Lot 27A (heifer calf, Beal Enhance 180) was born 8/18/20 and weighed 55 lbs. The calf is registered (19805103) and DNA has been submitted for the AngusGS genomic test. DNA results have been received, but not yet included in 180's EPDs, thus DNA results and interim EPDs are provided below. 158 showed heat on 9/24/20 and would be ready to breed or flush in October. Please take a close look at the DNA results below for 180 with top 1% WW, top 2% CW and MARB, and top 3% YW, SC, and DOC.

Genomic Percent Rank													
AnGS Results Recvd Date: 09/22/2020 File: 1738706 A-1314324 Beal Cattle Co, Glencoe OK													
CED	BW	WW	YW	DMI	YH	SC	Doc		HP	CEM	Milk	MW	MH
17	50	1	3	98	8	3	3		59	77	15	23	21
Ranks are based on 816,097 animals as of 05/29/2020													
CW	Marb	RE	FAT	Tend		Color	BVD						
2	2	15	88	39									



180		Beal Enhance 180												
Adj Yrlg	Birth Dt: 08/18/20	Cow								*19805103	Tattoo: 180			
Hip Ht	CED	BW	WW	YW	RADG	DMI	YH							
	I+10	20%	I+6	35%	I+70	10%	I+133	5%	I+31	5%	I+1.43	85%	I+9	15%
Adj Yrlg	SC	Doc	HP	CEM	Milk	MW	MH							
Scr Cir	I+1.67	10%	I+25	15%	I+10.1	65%	I+10	30%	I+26	40%	I+47	60%	I+5	30%
Adj	\$EN	CW	Marb	RE	Fat	\$M								
% IMF	-13	55%	I+58	15%	I+1.17	5%	I+.60	45%	I+.030	80%	+76	10%		
% IMF	SydGen Googol [DDF-OSF]										\$W	+76	10%	
Ratio	SydGen Exceed 3223 [AMF-CAF-XF]										\$F	+107	4%	
Adj RE	SydGen Enhance [AMF-CAF-XF]										\$G	+74	4%	
RE	18170041										\$B	+182	2%	
Ratio	SydGen Rita 2618										\$C	+312	1%	
Adj	Beal Sure Fire 158													
Rib Fat	+*19144027													
Rib Fat	G A R Sure Fire [AMF-CAF-XF]													
Ratio	Chair Rock 5050 G A R 8086 [DDC]													
	G A R Prophet [AMF-CAF-XF]													
	G A R Prophet N684 [OSF]													
	G A R Daybreak 1610 [DDF]													
	BW	CE	BWR	ADJ WW	WWR	ADJ YW	YWR	Test ADG	GR					
	55	1												
Adj Rump Fat														
Rump Fat Ratio														

Beal Cattle Co.
 12100 E Richmond Rd.
 Glencoe, OK 74032
 540-230-5049



Lot 28

Lot 28A (bull calf, G A R Quantum 200B) was born 8/24/20 and weighed 78 lbs. The calf is registered (19803265) and DNA has been submitted for the AngusGS genomic test. DNA results have not yet been received, but interim EPDs are provided below.

200B		G A R Quantum 200B												
Adj Yrlg	Birth Dt:	08/24/20					Bull					19803265	Tattoo:	200B
Hip Ht	CED	BW	WW	YW	RADG	DMI	YH							
	I+14	4%	I-2	20%	I+65	25%	I+114	25%	I+.25	40%	I+1.00	60%	I+.5	50%
Adj Yrlg	SC	Doc	HP	CEM	Milk	MW	MH							
Scr Cir	I+1.21	25%	I+25	15%	I+9.3	75%	I+12	15%	I+34	5%	I+48	60%	I+.4	40%
Adj	\$EN	CW	Marb	RE	Fat	\$M								
% IMF	-17	65%	I+49	30%	I+1.26	3%	I+.96	10%	I-.006	30%	+67			
											+30%			
% IMF												\$W		
Ratio												+82		
												4%		
												\$F		
Adj RE												+95		
												20%		
												\$G		
												I+86		
RE												1%		
Ratio												\$B		
												+181		
												2%		
Adj												\$C		
Rib Fat												+302		
												2%		
Rib Fat														
Ratio	BW	CE	BWR	ADJ WW	WWR	ADJ YW	YWR	Test ADG	GR					
	78	1												
Adj														
Rump Fat														
Rump														
Fat Ratio														



Lot 29

Lot 29A (heifer calf, Beal High Weigh 190) was born 8/22/20 and weighed 60 lbs. The calf is registered (19803773) and DNA has been submitted for the AngusGS genomic test. DNA results have been received and have been included in 190's EPDs, thus DNA results and full EPDs are provided below.

Genomic Percent Rank													
AnGS Results Recvd Date: 09/18/2020 File: 1738706 A-1314324 Beal Cattle Co, Glencoe OK													
CED	BW	WW	YW	DMI	YH	SC	Doc		HP	CEM	Milk	MW	MH
20	9	72	84	32	99	90	6		13	78	87	98	99
Ranks are based on 816,097 animals as of 05/29/2020													
CW	Marb	RE	FAT	Tend		Color	BVD	NEOGEN					
89	5	53	41	52									

Beal High Weigh 190									
Adj Yrkg	Birth Dt:	08/22/20	Angus GS	Cow	*19803773	Tattoo:	190		
Hip Ht	CED	BW	WW	YW	RADG	DMI	YH		
	+10 .32	-1 .48	+63 .42	+108 .37	+24 .31	+1.06 .31	+1 .43		
Adj Yrkg	SC	Doc	HP	CEM	Milk	MW	MH		
Scr Cir	-21 .39	+32 .34	+14.9 .19	+7 .27	+24 .27	+13 .34	-1 .37		
Adj	\$EN	CW	Marb	RE	Fat	\$M			
% IMF	+5	+35 .40	+1.15 .36	+58 .36	-.001 .32	+96			
% IMF	Sitz Upward 307R [AMF-CAF-XF]					\$W			
Ratio	Plattermere Weigh Up K360 [AMF-CAF-XF]					+74			
Adj RE	E W A High Weigh 3123 [AMF-CAF-XF]					\$F			
	Barbara of Plattermere 337 [DDF]								
	G A R New Design 5050 [DDC-AMF-XF]					+74			
	Edgewood Jaunty 128 [DDF]					\$G			
	Edgewood Jaunty 935					+76			
RE	G A R Prophet [AMF-CAF-XF]					\$B			
Ratio	G A R Proactive [AMF-CAF-XF]					+150			
	G A R Daybreak 1521 [DDF]					\$C			
Adj Rib Fat	Beal Proactive 238					+291			
	*19395301								
	G A R Advance [DDF]								
	H P C A Advance A175 [DDF-OSF]								
	G A R 5050 New Design A935 [DDC-AMF]								
Rib Fat	BW	CE	BWR	ADJ WW	WWR	ADJ YW	YWR	Test ADG	GR
Ratio	60	1							
Adj Rump Fat									
Rump Fat Ratio									

Lot 30

Lot 30A (bull calf, Beal Quantum 390B) was born 9/29/20 and weighed 62 lbs. The calf is registered (19829110) and DNA has been submitted for the AngusGS genomic test. DNA results have not yet been received, but interim EPDs are provided below.

Beal Quantum 390B									
Adj Yrkg	Birth Dt:	09/29/20	Bull	19829110	Tattoo:	390B			
Hip Ht	CED	BW	WW	YW	RADG	DMI	YH		
	I+12 .05	I+1.0 .05	I+66 .05	I+118 .05	I+27 .05	I+98 .05	I+7 .05		
Adj Yrkg	SC	Doc	HP	CEM	Milk	MW	MH		
Scr Cir	I+.57 .05	I+22 .05	I+9.2 .05	I+10 .05	I+32 .05	I+65 .05	I+.8 .05		
Adj	\$EN	CW	Marb	RE	Fat	\$M			
% IMF	-24	I+51 .05	I+1.05 .05	I+1.06 .05	I-.019 .05	+60			
% IMF	G A R Progress [DDC-CAF-XF]					\$W			
Ratio	G A R Momentum [CAF-D2F-XF]					+77			
	G A R Quantum [AMF-CAF-XF]					\$F			
	G A R Big Eye 1770 [DDF]								
Adj RE	Connealy In Sure 8524 [AMF-CAF-XF]					+97			
	G A R In Sure 1524 [OSF]					\$G			
	G A R Complete 3011 [DDF]					+79			
RE	MCC Daybreak [AMF-CAF-XF]					\$B			
Ratio	G A R Sunrise [AMF-CAF-XF]					+176			
	G A R Objective R227					\$C			
Adj Rib Fat	Beal Sunrise 038					+288			
	*19143946								
	Maplecrest Rita K3245								
	Connealy Confidence 0100 [CAF-DDF-XF]								
	G A R 5050 New Design 669 [DDF]								
Rib Fat	BW	CE	BWR	ADJ WW	WWR	ADJ YW	YWR	Test ADG	GR
Ratio	62	1	81						
Adj Rump Fat									
Rump Fat Ratio									



Lot 33	258 was checked pregnant in September and due to calve 4/17/21 to SydGen Enhance.																																																																																																																																																																																																																																																																																																								
Lot 34	208 had a calf and thus should not be considered a heifer. 208 calved 3/11/20 (calf is not in the sale) and was bred AI in June but did not conceive. She was not pasture exposed to a bull. She was checked open in September. Sells OPEN and ready to breed or flush with a breeding guarantee.																																																																																																																																																																																																																																																																																																								
Lot 35	S29 was checked pregnant in September and due to calve 4/17/21 to SydGen Enhance. S29 had an abscess on her back-left leg that was treated on 9/25/20 and 9/28/20. She is fully guaranteed.																																																																																																																																																																																																																																																																																																								
Lot 36	058 had a calf and thus should not be considered a heifer. 058 calved 4/11/20 (calf is not in the sale) and was bred AI in June but did not conceive. She was not pasture exposed to a bull. She was checked open in September. Sells OPEN and ready to breed or flush with a breeding guarantee.																																																																																																																																																																																																																																																																																																								
Lot 42	<p>Lot 42A (bull calf, Beal Prophet K263 290B) was born 9/16/20 and weighed 82 lbs. The calf is registered (19819096) and DNA has been submitted for the AngusGS genomic test. DNA results have not yet been received, but interim EPDs are provided below.</p> <table border="1"> <thead> <tr> <th colspan="2">290B</th> <th colspan="11">Beal Prophet K263 290B</th> </tr> <tr> <td>Adj Yrlg</td> <td>Birth Dt: 09/16/20</td> <td colspan="5">Bull</td> <td colspan="5">19819096</td> <td>Tattoo: 290B</td> </tr> <tr> <td>Hip Ht</td> <td>CED</td> <td>BW</td> <td>WW</td> <td>YW</td> <td>RADG</td> <td>DMI</td> <td>YH</td> <td colspan="5"></td> </tr> </thead> <tbody> <tr> <td></td> <td>I+11</td> <td>15%</td> <td>I-1</td> <td>25%</td> <td>I+71</td> <td>10%</td> <td>I+133</td> <td>5%</td> <td>I+30</td> <td>10%</td> <td>I+1.65</td> <td>95%</td> <td>I+9</td> <td>15%</td> </tr> <tr> <td>Adj Yrlg</td> <td>SC</td> <td>Doc</td> <td>HP</td> <td>CEM</td> <td>Milk</td> <td>MW</td> <td>MH</td> <td colspan="5"></td> </tr> <tr> <td>Scr Cir</td> <td>I-.06</td> <td>95%</td> <td>I+26</td> <td>15%</td> <td>I+14.7</td> <td>15%</td> <td>I+13</td> <td>10%</td> <td>I+33</td> <td>10%</td> <td>I+59</td> <td>45%</td> <td>I+8</td> <td>10%</td> </tr> <tr> <td>Adj</td> <td colspan="2">\$EN</td> <td colspan="2">CW</td> <td colspan="2">Marb</td> <td colspan="2">RE</td> <td colspan="2">Fat</td> <td>\$M</td> <td colspan="3"></td> </tr> <tr> <td>% IMF</td> <td>-22</td> <td>80%</td> <td>I+62</td> <td>10%</td> <td>I+.98</td> <td>10%</td> <td>I+.82</td> <td>15%</td> <td>I+0</td> <td>35%</td> <td>+83</td> <td>3%</td> <td colspan="2"></td> </tr> <tr> <td>% IMF</td> <td colspan="10"></td> <td>\$W</td> <td>+83</td> <td>3%</td> </tr> <tr> <td>Ratio</td> <td colspan="10"></td> <td>\$F</td> <td>+85</td> <td>3%</td> </tr> <tr> <td>Adj RE</td> <td colspan="10"></td> <td>\$G</td> <td>+109</td> <td>4%</td> </tr> <tr> <td>RE</td> <td colspan="10"></td> <td>\$B</td> <td>+71</td> <td>10%</td> </tr> <tr> <td>Ratio</td> <td colspan="10"></td> <td>\$C</td> <td>+180</td> <td>2%</td> </tr> <tr> <td>Adj Rib Fat</td> <td colspan="10"></td> <td>\$C</td> <td>+316</td> <td>1%</td> </tr> <tr> <td>Rib Fat</td> <td colspan="10"></td> <td>1%</td> <td colspan="2"></td> </tr> <tr> <td>Ratio</td> <td>BW</td> <td>CE</td> <td>BWR</td> <td>ADJ WW</td> <td>WWR</td> <td>ADJ YW</td> <td>YWR</td> <td>Test ADG</td> <td>GR</td> <td colspan="5"></td> </tr> <tr> <td></td> <td>82</td> <td>1</td> <td></td> <td></td> <td></td> <td></td> <td></td> <td></td> <td></td> <td colspan="5"></td> </tr> <tr> <td>Adj Rump Fat</td> <td colspan="5">Dam's Production Record</td> <td colspan="5">Dam's Ultrasound Production Record</td> </tr> <tr> <td></td> <td>ACT BW</td> <td>BWR</td> <td>WWR</td> <td>YWR</td> <td>% IMF</td> <td>RE</td> <td>Fat</td> <td>RU Fat</td> <td colspan="6"></td> </tr> <tr> <td></td> <td>1-64</td> <td>1-88</td> <td>1-92</td> <td>1-96</td> <td></td> <td></td> <td></td> <td></td> <td colspan="6"></td> </tr> <tr> <td>Rump Fat Ratio</td> <td colspan="14"></td> </tr> </tbody> </table>	290B		Beal Prophet K263 290B											Adj Yrlg	Birth Dt: 09/16/20	Bull					19819096					Tattoo: 290B	Hip Ht	CED	BW	WW	YW	RADG	DMI	YH							I+11	15%	I-1	25%	I+71	10%	I+133	5%	I+30	10%	I+1.65	95%	I+9	15%	Adj Yrlg	SC	Doc	HP	CEM	Milk	MW	MH						Scr Cir	I-.06	95%	I+26	15%	I+14.7	15%	I+13	10%	I+33	10%	I+59	45%	I+8	10%	Adj	\$EN		CW		Marb		RE		Fat		\$M				% IMF	-22	80%	I+62	10%	I+.98	10%	I+.82	15%	I+0	35%	+83	3%			% IMF											\$W	+83	3%	Ratio											\$F	+85	3%	Adj RE											\$G	+109	4%	RE											\$B	+71	10%	Ratio											\$C	+180	2%	Adj Rib Fat											\$C	+316	1%	Rib Fat											1%			Ratio	BW	CE	BWR	ADJ WW	WWR	ADJ YW	YWR	Test ADG	GR							82	1													Adj Rump Fat	Dam's Production Record					Dam's Ultrasound Production Record						ACT BW	BWR	WWR	YWR	% IMF	RE	Fat	RU Fat								1-64	1-88	1-92	1-96											Rump Fat Ratio														
290B		Beal Prophet K263 290B																																																																																																																																																																																																																																																																																																							
Adj Yrlg	Birth Dt: 09/16/20	Bull					19819096					Tattoo: 290B																																																																																																																																																																																																																																																																																													
Hip Ht	CED	BW	WW	YW	RADG	DMI	YH																																																																																																																																																																																																																																																																																																		
	I+11	15%	I-1	25%	I+71	10%	I+133	5%	I+30	10%	I+1.65	95%	I+9	15%																																																																																																																																																																																																																																																																																											
Adj Yrlg	SC	Doc	HP	CEM	Milk	MW	MH																																																																																																																																																																																																																																																																																																		
Scr Cir	I-.06	95%	I+26	15%	I+14.7	15%	I+13	10%	I+33	10%	I+59	45%	I+8	10%																																																																																																																																																																																																																																																																																											
Adj	\$EN		CW		Marb		RE		Fat		\$M																																																																																																																																																																																																																																																																																														
% IMF	-22	80%	I+62	10%	I+.98	10%	I+.82	15%	I+0	35%	+83	3%																																																																																																																																																																																																																																																																																													
% IMF											\$W	+83	3%																																																																																																																																																																																																																																																																																												
Ratio											\$F	+85	3%																																																																																																																																																																																																																																																																																												
Adj RE											\$G	+109	4%																																																																																																																																																																																																																																																																																												
RE											\$B	+71	10%																																																																																																																																																																																																																																																																																												
Ratio											\$C	+180	2%																																																																																																																																																																																																																																																																																												
Adj Rib Fat											\$C	+316	1%																																																																																																																																																																																																																																																																																												
Rib Fat											1%																																																																																																																																																																																																																																																																																														
Ratio	BW	CE	BWR	ADJ WW	WWR	ADJ YW	YWR	Test ADG	GR																																																																																																																																																																																																																																																																																																
	82	1																																																																																																																																																																																																																																																																																																							
Adj Rump Fat	Dam's Production Record					Dam's Ultrasound Production Record																																																																																																																																																																																																																																																																																																			
	ACT BW	BWR	WWR	YWR	% IMF	RE	Fat	RU Fat																																																																																																																																																																																																																																																																																																	
	1-64	1-88	1-92	1-96																																																																																																																																																																																																																																																																																																					
Rump Fat Ratio																																																																																																																																																																																																																																																																																																									



Lot 43

Lot 43A (heifer calf, Beal Ashland 240) was born 8/30/20 and weighed 80 lbs. The calf is registered (19803267) and DNA has been submitted for the AngusGS genomic test. DNA results have not yet been received, but interim EPDs are provided below.

240 Beal Ashland 240												
Adj Yrkg		Cow 19803267										Tattoo: 240
Birth Dt:	08/30/20											
Hip Ht	CED	BW	WW	YW	RADG	DMI	YH					
I+9	25%	I+1.7	60%	I+6.7	15%	I+11.7	20%	I+2.6	30%	I+0.96	60%	I+7.30%
Adj Yrkg	SC	Doc	HP	CEM	Milk	MW	MH					
I+1.66	60%	I+2.3	25%	I+11.9	40%	I+11	20%	I+2.6	40%	I+6.6	35%	I+5.30%
Adj	SEN	CW	Marb	RE	Fat	SM						
% IMF	-21	80%	I+5.2	25%	I+1.18	4%	I+8.3	15%	I-.009	25%	+60	50%
% IMF	G A R Early Bird [DDF]											
Ratio	G A R Ashland [AMF-CAF-XF]											
Adj RE	+*18217198											
RE	SydGen Googol [DDF-OSF]											
Ratio	SydGen Exceed 3223 [AMF-CAF-XF]											
Adj	SydGen Jannet 7304 [AMF-NHF]											
Rib Fat	18811659											
Rib Fat	BW	CE	BWR	ADJ WW	WWR	ADJ YW	YWR	Test ADG	GR			
Ratio	80	1										
Adj	Dam's Production Record											
Rump Fat	ACT BW	BWR	WWR	YWR	% IMF	RE	Fat	RU Fat				
Ratio	1-74	1-100	1-98	1-105								
Rump	Dam's Ultrasound Production Record											
Fat Ratio												

Lot 44

Lot 44A (heifer calf, Beal Enhance 210) was born 8/25/20 and weighed 85 lbs. The calf is registered (19805121) and DNA has been submitted for the AngusGS genomic test. DNA results have been received, but not yet included in 210's EPDs, thus DNA results and interim EPDs are provided below.

Genomic Percent Rank												
AnGS Results Recvd Date: 09/22/2020 File: 1738706 A-1314324 Beal Cattle Co, Glencoe OK												
CED	BW	WW	YW	DMI	YH	SC	Doc	HP	CEM	Milk	MW	MH
62	63	3	18	93	9	25	13	12	46	49	24	33
CW	Marb	RE	FAT	Tend	Color	BVD	Ranks are based on 816,097 animals as of 05/29/2020					
6	27	8	49	61			NEOGEN					

210 Beal Enhance 210												
Adj Yrkg		Cow *19805121										Tattoo: 210
Birth Dt:	08/25/20											
Hip Ht	CED	BW	WW	YW	RADG	DMI	YH					
I+8	35%	I+9	40%	I+7.0	10%	I+13.2	5%	I+3.2	3%	I+1.17	75%	I+7.30%
Adj Yrkg	SC	Doc	HP	CEM	Milk	MW	MH					
I+1.64	10%	I+3.0	4%	I+8.9	80%	I+10	30%	I+2.7	30%	I+6.9	35%	I+5.30%
Adj	SEN	CW	Marb	RE	Fat	SM						
% IMF	-23	85%	I+5.8	15%	I+1.03	10%	I+9.1	10%	I+0.02	40%	+62	45%
% IMF	SydGen Googol [DDF-OSF]											
Ratio	SydGen Exceed 3223 [AMF-CAF-XF]											
Adj RE	18170041											
RE	SydGen Liberty GA 8627 [AMF-CAF-XF]											
Ratio	SydGen Rita 2618											
Adj	Fox Run Rita 9308 [CAF]											
Rib Fat	K C F Bennett Absolute [AMF-CAF-XF]											
Rib Fat	G A R Absolute N1366											
Ratio	+*18766801											
Rib Fat	BW	CE	BWR	ADJ WW	WWR	ADJ YW	YWR	Test ADG	GR			
Ratio	85	1										
Adj	Dam's Production Record											
Rump Fat	ACT BW	BWR	WWR	YWR	% IMF	RE	Fat	RU Fat				
Ratio	1-87	1-110	1-92	1-91								
Rump	Dam's Ultrasound Production Record											
Fat Ratio												



Lot 45	<p>Lot 45A (bull calf, Beal Quantum 320B) was born 9/20/20 and weighed 90 lbs. The calf is registered (19824897) and DNA has been submitted for the AngusGS genomic test. DNA results have not yet been received, but interim EPDs are provided below.</p>																																																																																																																																																																																																																																							
	<p>Beal Quantum 320B</p> <table border="1"> <tr> <td>Adj Yrlg Hip Ht</td> <td>Birth Dt: 09/20/20</td> <td>Bull</td> <td>19824897</td> <td>Tattoo:</td> <td>320B</td> </tr> <tr> <td></td> <td>CED</td> <td>BW</td> <td>WW</td> <td>YW</td> <td>RADG</td> <td>DMI</td> <td>YH</td> </tr> <tr> <td></td> <td>I+8 .05</td> <td>I+1.7 .05</td> <td>I+71 .05</td> <td>I+120 .05</td> <td>I+.26 .05</td> <td>I+1.02 .05</td> <td>I+.7 .05</td> </tr> <tr> <td>Adj Yrlg Scr Cir</td> <td>SC</td> <td>Doc</td> <td>HP</td> <td>CEM</td> <td>Milk</td> <td>MW</td> <td>MH</td> </tr> <tr> <td></td> <td>I+1.39 .05</td> <td>I+26 .05</td> <td>I+11.1 .05</td> <td>I+9 .05</td> <td>I+36 .05</td> <td>I+69 .05</td> <td>I+.8 .05</td> </tr> <tr> <td>Adj % IMF</td> <td>\$EN</td> <td>CW</td> <td>Marb</td> <td>RE</td> <td>Fat</td> <td>\$M</td> <td></td> </tr> <tr> <td></td> <td>-28</td> <td>I+49 .05</td> <td>I+1.24 .05</td> <td>I+.93 .05</td> <td>I-.010 .05</td> <td>+67</td> <td></td> </tr> <tr> <td>% IMF Ratio</td> <td colspan="6">G A R Quantum [AMF-CAF-XF]</td> <td>\$W</td> <td></td> </tr> <tr> <td></td> <td colspan="6">G A R Momentum [CAF-D2F-XF]</td> <td>+86</td> <td></td> </tr> <tr> <td></td> <td colspan="6">G A R Big Eye 1770 [DDF]</td> <td>\$F</td> <td></td> </tr> <tr> <td>Adj RE</td> <td colspan="6">+*18636059</td> <td>+88</td> <td></td> </tr> <tr> <td></td> <td colspan="6">G A R In Sure 1524 [OSF]</td> <td>\$G</td> <td></td> </tr> <tr> <td></td> <td colspan="6">Connealy In Sure 8524 [AMF-CAF-XF]</td> <td>+85</td> <td></td> </tr> <tr> <td>RE Ratio</td> <td colspan="6">G A R Complete 3011 [DDF]</td> <td>\$B</td> <td></td> </tr> <tr> <td></td> <td colspan="6">G A R New Design 5050 [DDC-AMF-XF]</td> <td>+173</td> <td></td> </tr> <tr> <td>Adj Rib Fat</td> <td colspan="6">H P C A Composure A235</td> <td>\$C</td> <td></td> </tr> <tr> <td></td> <td colspan="6">+*18505015</td> <td>+291</td> <td></td> </tr> <tr> <td></td> <td colspan="6">B/R Ambush 28 [AMF-CAF-XF]</td> <td></td> <td></td> </tr> <tr> <td></td> <td colspan="6">H P C A Ambush 2021</td> <td></td> <td></td> </tr> <tr> <td></td> <td colspan="6">GAR Objective F117 [DDF]</td> <td></td> <td></td> </tr> <tr> <td>Rib Fat Ratio</td> <td>BW</td> <td>CE</td> <td>BWR</td> <td>ADJ WW</td> <td>WWR</td> <td>ADJ YW</td> <td>YWR</td> <td>Test ADG</td> <td>GR</td> </tr> <tr> <td></td> <td>90</td> <td>1</td> <td></td> <td></td> <td></td> <td></td> <td></td> <td></td> <td></td> </tr> <tr> <td>Adj Rump Fat</td> <td colspan="4">Dam's Production Record</td> <td colspan="5">Dam's Ultrasound Production Record</td> </tr> <tr> <td></td> <td>ACT BW</td> <td>BWR</td> <td>WWR</td> <td>YWR</td> <td>% IMF</td> <td>RE</td> <td>Fat</td> <td>RU Fat</td> <td></td> </tr> <tr> <td></td> <td>2-68</td> <td>2-98</td> <td>2-105</td> <td>2-95</td> <td>4-102</td> <td>4-93</td> <td>4-80</td> <td>4-79</td> <td></td> </tr> <tr> <td>Rump Fat Ratio</td> <td colspan="9"></td> </tr> </table>	Adj Yrlg Hip Ht	Birth Dt: 09/20/20	Bull	19824897	Tattoo:	320B		CED	BW	WW	YW	RADG	DMI	YH		I+8 .05	I+1.7 .05	I+71 .05	I+120 .05	I+.26 .05	I+1.02 .05	I+.7 .05	Adj Yrlg Scr Cir	SC	Doc	HP	CEM	Milk	MW	MH		I+1.39 .05	I+26 .05	I+11.1 .05	I+9 .05	I+36 .05	I+69 .05	I+.8 .05	Adj % IMF	\$EN	CW	Marb	RE	Fat	\$M			-28	I+49 .05	I+1.24 .05	I+.93 .05	I-.010 .05	+67		% IMF Ratio	G A R Quantum [AMF-CAF-XF]						\$W			G A R Momentum [CAF-D2F-XF]						+86			G A R Big Eye 1770 [DDF]						\$F		Adj RE	+*18636059						+88			G A R In Sure 1524 [OSF]						\$G			Connealy In Sure 8524 [AMF-CAF-XF]						+85		RE Ratio	G A R Complete 3011 [DDF]						\$B			G A R New Design 5050 [DDC-AMF-XF]						+173		Adj Rib Fat	H P C A Composure A235						\$C			+*18505015						+291			B/R Ambush 28 [AMF-CAF-XF]									H P C A Ambush 2021									GAR Objective F117 [DDF]								Rib Fat Ratio	BW	CE	BWR	ADJ WW	WWR	ADJ YW	YWR	Test ADG	GR		90	1								Adj Rump Fat	Dam's Production Record				Dam's Ultrasound Production Record						ACT BW	BWR	WWR	YWR	% IMF	RE	Fat	RU Fat			2-68	2-98	2-105	2-95	4-102	4-93	4-80	4-79		Rump Fat Ratio									
Adj Yrlg Hip Ht	Birth Dt: 09/20/20	Bull	19824897	Tattoo:	320B																																																																																																																																																																																																																																			
	CED	BW	WW	YW	RADG	DMI	YH																																																																																																																																																																																																																																	
	I+8 .05	I+1.7 .05	I+71 .05	I+120 .05	I+.26 .05	I+1.02 .05	I+.7 .05																																																																																																																																																																																																																																	
Adj Yrlg Scr Cir	SC	Doc	HP	CEM	Milk	MW	MH																																																																																																																																																																																																																																	
	I+1.39 .05	I+26 .05	I+11.1 .05	I+9 .05	I+36 .05	I+69 .05	I+.8 .05																																																																																																																																																																																																																																	
Adj % IMF	\$EN	CW	Marb	RE	Fat	\$M																																																																																																																																																																																																																																		
	-28	I+49 .05	I+1.24 .05	I+.93 .05	I-.010 .05	+67																																																																																																																																																																																																																																		
% IMF Ratio	G A R Quantum [AMF-CAF-XF]						\$W																																																																																																																																																																																																																																	
	G A R Momentum [CAF-D2F-XF]						+86																																																																																																																																																																																																																																	
	G A R Big Eye 1770 [DDF]						\$F																																																																																																																																																																																																																																	
Adj RE	+*18636059						+88																																																																																																																																																																																																																																	
	G A R In Sure 1524 [OSF]						\$G																																																																																																																																																																																																																																	
	Connealy In Sure 8524 [AMF-CAF-XF]						+85																																																																																																																																																																																																																																	
RE Ratio	G A R Complete 3011 [DDF]						\$B																																																																																																																																																																																																																																	
	G A R New Design 5050 [DDC-AMF-XF]						+173																																																																																																																																																																																																																																	
Adj Rib Fat	H P C A Composure A235						\$C																																																																																																																																																																																																																																	
	+*18505015						+291																																																																																																																																																																																																																																	
	B/R Ambush 28 [AMF-CAF-XF]																																																																																																																																																																																																																																							
	H P C A Ambush 2021																																																																																																																																																																																																																																							
	GAR Objective F117 [DDF]																																																																																																																																																																																																																																							
Rib Fat Ratio	BW	CE	BWR	ADJ WW	WWR	ADJ YW	YWR	Test ADG	GR																																																																																																																																																																																																																															
	90	1																																																																																																																																																																																																																																						
Adj Rump Fat	Dam's Production Record				Dam's Ultrasound Production Record																																																																																																																																																																																																																																			
	ACT BW	BWR	WWR	YWR	% IMF	RE	Fat	RU Fat																																																																																																																																																																																																																																
	2-68	2-98	2-105	2-95	4-102	4-93	4-80	4-79																																																																																																																																																																																																																																
Rump Fat Ratio																																																																																																																																																																																																																																								
Lot 46	N684 Sells COMMERCIAL without registration papers.																																																																																																																																																																																																																																							
Lot 47	Flushed 2 times to average 6 embryos. A226 calved on 3/21/20 (calf is not in the sale) and showed heat and was bred AI in June but did not conceive. She was not pasture exposed to a bull. She was checked open in September. Sells OPEN and ready to breed or flush with a breeding guarantee.																																																																																																																																																																																																																																							